

Mar 22-1886-

Survey of Estate of Samuel GATES

N.E. 1/4 Sec. 18 T6 NR 1W

S 57° 47' E  
085.74

N 71° 05' 30" E  
177.00

1.25

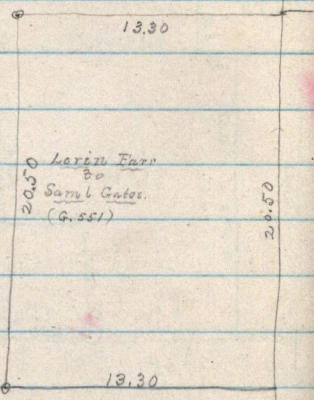

Lavin Farr  
Bo  
Saml Gates.  
(G. 551)

13.30

13.30

20.50

20.50

1.25